

Clarke®

air

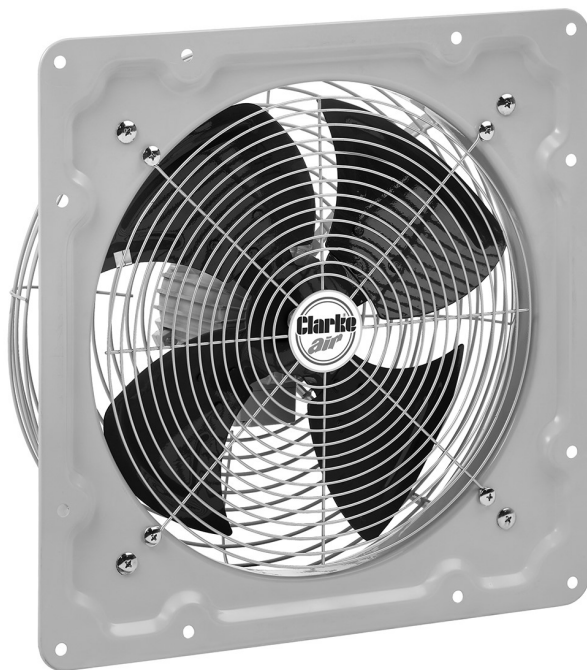

16" PLATE AXIAL EXHAUST FAN

MODEL NO: CAF16

PART NO: 3230491

OPERATION & MAINTENANCE INSTRUCTIONS

UK
CA | CE



ORIGINAL INSTRUCTIONS

DL1025

INTRODUCTION

Thank you for purchasing this CLARKE Plate Axial Exhaust Fan.

Before attempting to use this product, please read this manual thoroughly and follow the instructions carefully. In doing so you will ensure the safety of yourself and that of others around you, and you can look forward to your purchase giving you long and satisfactory service.

GUARANTEE

This product is guaranteed against faulty manufacture for a period of 12 months from the date of purchase. Please keep your receipt which will be required as proof of purchase.

This guarantee is invalid if the product is found to have been abused or tampered with in any way, or not used for the purpose for which it was intended.

Faulty goods should be returned to their place of purchase, no product can be returned to us without prior permission.

This guarantee does not effect your statutory rights.

ENVIRONMENTAL RECYCLING POLICY



Through purchase of this product, the customer is taking on the obligation to deal with the WEEE in accordance with the WEEE regulations in relation to the treatment, recycling & recovery and environmentally sound disposal of the WEEE.

In effect, this means that this product must not be disposed of with general household waste. It must be disposed of according to the laws governing Waste Electrical and Electronic Equipment (WEEE) at a recognized disposal facility.

At the end of its working life, do not dispose of this product or its components with general household waste. Any tools, accessories and packaging should be sorted, taken to a recycling centre and disposed of appropriately.

GENERAL SAFETY WARNINGS

NOTE: This product **DOES NOT** come with a plug, for electrical connectivity please consult pages 4-5 of this manual.

1. Please keep these instructions in a safe place for future reference.
2. **NEVER** carry out any alterations or modifications to this product.
3. **NEVER** carry out any maintenance on this product unless the power has been isolated.
4. Inspect the power cable and plug (if used) for damage and ensure that no connections are loose. **DO NOT** use this unit if it has a damaged supply cable. Any damage should be properly repaired or the part replaced.
5. **DO NOT** use an adaptor plug with earthed (grounded) appliances. Correct plugs and outlets will reduce the risk of electric shock.
6. Position the power cable so that it cannot be inadvertently pulled or pinched and where it does not cause a trip hazard.
7. **NEVER** abuse the mains cable or wrench the cable to disconnect it from the socket. Keep the cable away from sharp edges or hot surfaces.
8. **NEVER** insert anything into the fan grille, unless the power has been isolated.
9. Store or install this product in a dry and secure place out of reach of children.

ELECTRICAL CONNECTIONS



WARNING: READ THESE ELECTRICAL SAFETY INSTRUCTIONS THOROUGHLY BEFORE CONNECTING THE PRODUCT TO THE MAINS SUPPLY.

Before switching the product on, make sure that the voltage of your electricity supply is the same as that indicated on the rating plate. This product is designed to operate on 230VAC 50Hz. Connecting it to any other power source may cause damage.

This product can be used with either a standard plug or a fused connection unit (FCU). If it is necessary to change the fuse in the plug or FCU, the fuse cover must be refitted. If the fuse cover becomes lost or damaged, the plug or FCU must not be used until a suitable replacement is obtained.

If the plug has to be changed because it is not suitable for your socket, or due to damage, a replacement should be fitted, following the wiring instructions shown on page 5. The old plug must be disposed of safely, as insertion into a mains socket could cause an electrical hazard.

If the colours of the wires in the power cable of this product do not correspond with the markings on the terminals of your plug or spur, proceed as follows.

- The **Blue** wire must be connected to the terminal which is marked **N** or coloured **Black**.
- The **Brown** wire must be connected to the terminal which is marked **L** or coloured **Red**.
- The **Yellow and Green** wire must be connected to the terminal which is marked **E**, \perp or coloured **Green**.

Fused Connection Unit (FCU) must be BS1363/4 approved.

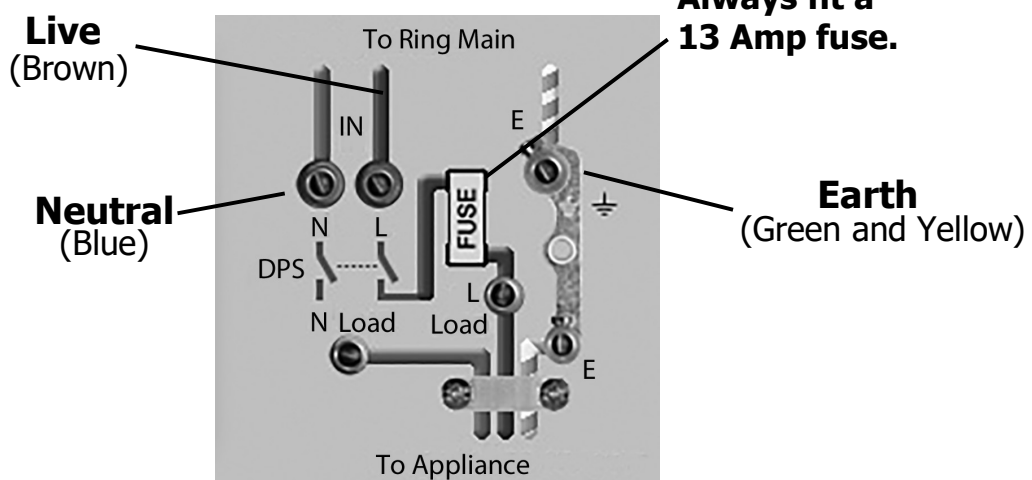

Ensure that the outer sheath of the cable is firmly held by the clamp

Plug must be BS1363/A approved.

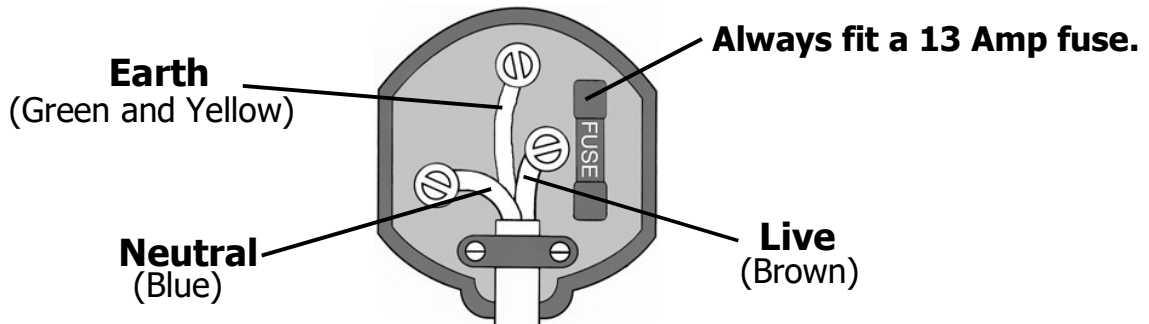

Ensure that the outer sheath of the cable is firmly held by the clamp

If in any doubt, consult a qualified electrician.

INSTALLATION

1. Before installation, ensure that the impeller has not been damaged or distorted during transit.
2. Check that the impeller rotates freely and is secured tightly to the shaft. If the tip clearance of the blades is not sufficient slacken the motor bolts and re-align.
3. Mount the fan securely using 4 bolt/screw holes provided in the outer casing. Using the other 4 bolt holes and appropriate length bolts, the fan can be aligned and secured with the corresponding sized external louvre vent (see below).
4. Ensure that the installation is free from any vibration which could damage the impeller or motor bearings.
5. Ensure that when installed the impeller side of the fan cannot be touched.
6. For safety and security a Louvre shutter/vent should be installed on the external wall. These can be purchased from your local CLARKE retailer.

MODEL No.	DESCRIPTION	PART No.	
CL12	12" Louvre Vent	3230494	
CL16	16" Louvre Vent	3230495	
CL20	20" Louvre Vent	3230496	
CL24	24" Louvre Vent	3230497	

7. Refer to the section on electrical connection on pages 4-5 for guidance on wiring. If in any doubt, consult a qualified electrician.

MAINTENANCE

Before carrying out any maintenance, always make sure that the power has been isolated.

1. Check that the impeller and motor bolts and nuts are fully tightened within the first 100 hours of use and periodically after this.
2. Ensure that the impeller, motor and fan housing are kept clean. This is important for the ongoing safe use of this fan.
3. Periodically check that the fan installation is free from corrosion.
4. If not installed, store in a dry place protected from the weather.
5. **DO NOT** attempt any repairs yourself, always consult a qualified electrician or contact the CLARKE service department.

Your CLARKE fan has been designed to give long and trouble free service. If, however, having followed the instructions in this booklet carefully, you encounter problems, take the unit to your local CLARKE dealer.

TECHNICAL DATA

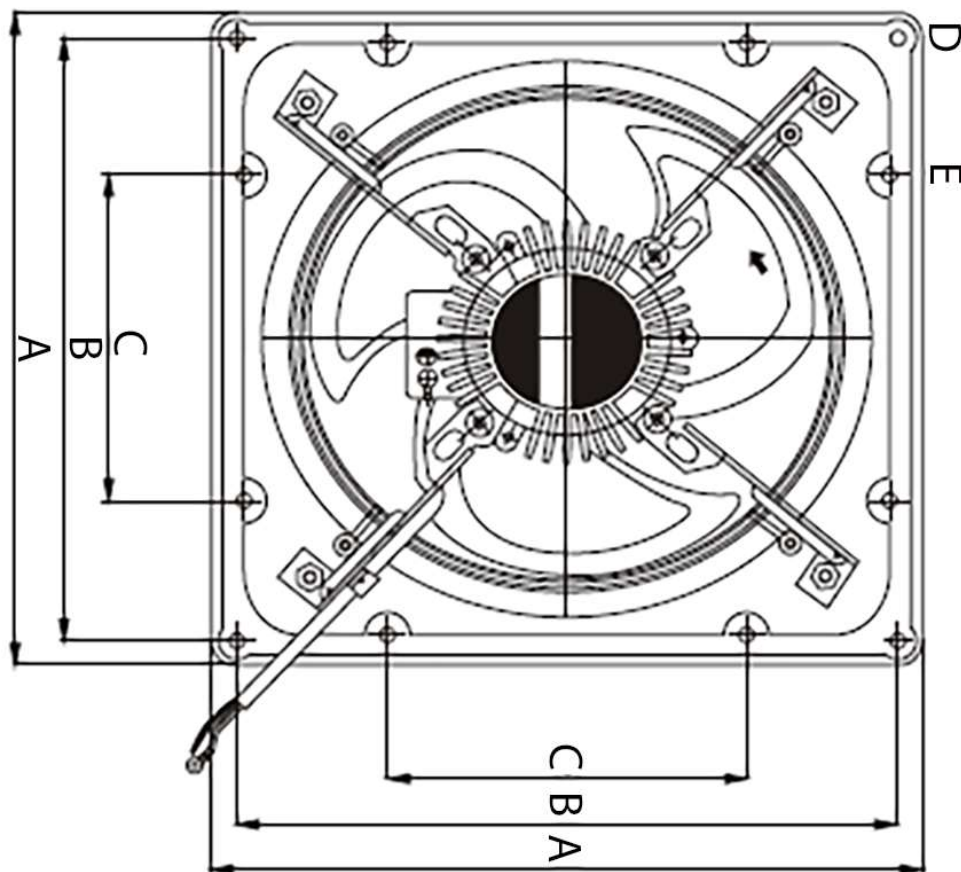
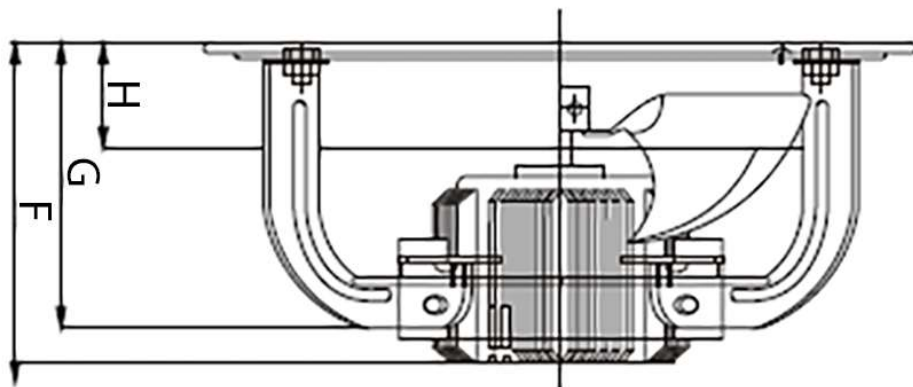

Model	A	B	C	D	E	F	G	H
CAF16	500mm	462mm	243mm	10mm	10mm	215mm	180mm	70mm

DIAGRAM

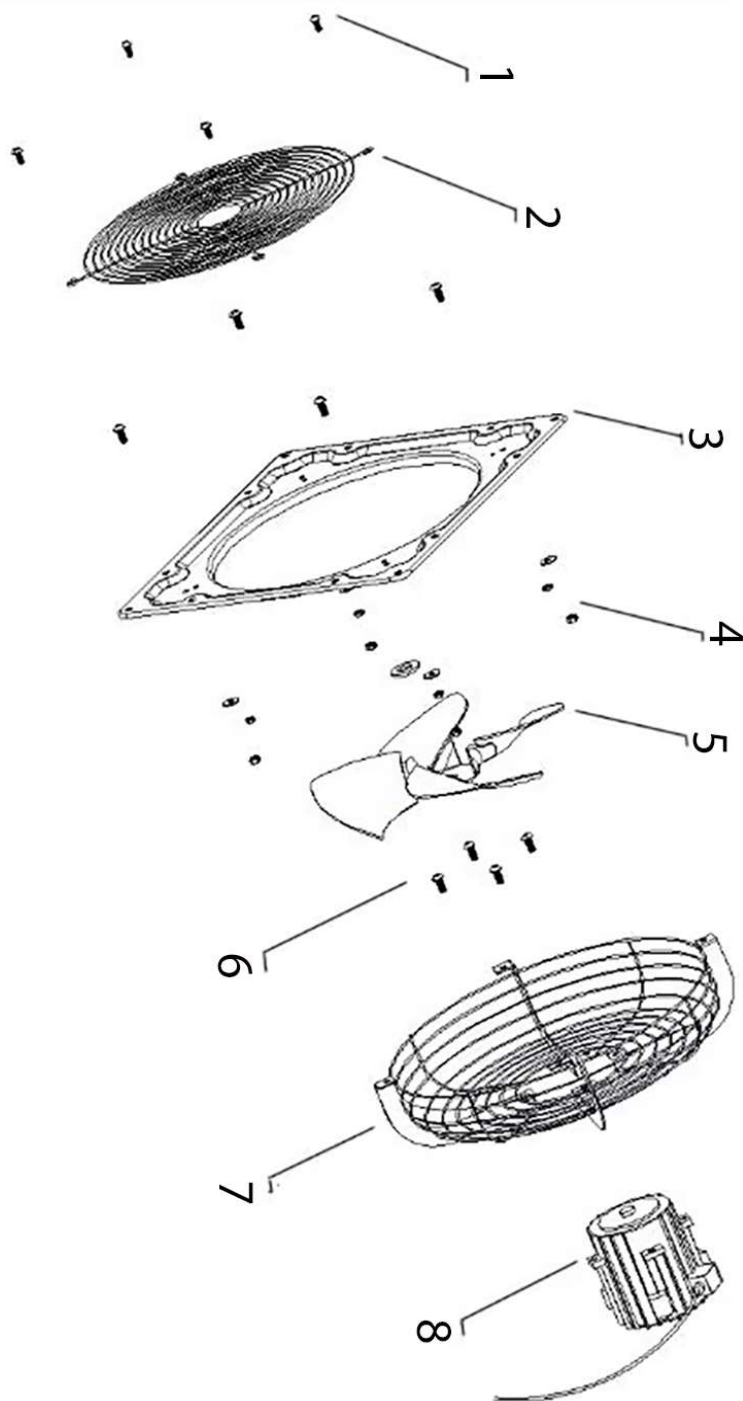

No	Part	No	Part
1	Screw	5	Impeller
2	Safety Grille	6	Motor Screw
3	Frame	7	Safety Grille
4	Impeller Screw	8	Motor

TECHNICAL SPECIFICATIONS

Model	CAF16
Impeller Size	400mm (16")
Voltage/Frequency	230 Volts/50 Hz
Power Cable	3 Core x 1.0mm ² x 1.5m
Electrical Insulation Class	Class I
Speed	1400 rpm
Power Input	150 Watts
Rated Input Ampage	0.68A
Service Value	0.38m ³ /min/W
Standby Power Consumption	N/A
Fan Sound Power Level	54dB (A)
Airflow at Optimum Energy Efficiency	58m ³ /min
Static Pressure at Optimum Efficiency	90pa
Operating Temperature	-15°C ~ 40°C (5°F ~ 104°F)
Weight	9.2 kg
IP Rating	IP54

ERP - THE FOLLOWING TABLE ADDRESSES THE INFORMATION REQUIREMENTS OF REG.327/2011

Model	CAF16		
Description	Symbol	Value	Unit
Overall Efficiency	-	72.70	%
Measurement Category	-	B	A,B,C or D
Efficiency Category	-	Total	Static/Total
Efficiency Grade	-	N = 58	-
Efficiency Calculation with VSD	-	Without VSD	-
Variable Speed Drive	-	No	Yes/No
Rated Flow Rate at Optimum Energy Efficiency	F	3480	m ³ /hr
Rated Motor Power input at Optimum Energy Efficiency	P	150	W
Rated Pressure Rate at Optimum Energy Efficiency	Pa	101.3	Pa
Rotations Per Minute at Optimum Energy Efficiency	RPM	1400	RPM
The "Specific Ratio" (EU No 327/2011)	-	N/A	-
Recycling Information	Adhere to WEEE standards		
Contact Details for Obtaining More Information	Clarke International Hemnall Street, Epping, Essex, CM16 4LG service@clarkeinternational.com Tel: 0208 988 7400		

DECLARATION OF CONFORMITY



Hennell Street, Epping, Essex, CM16 4LG

DECLARATION OF CONFORMITY

This is an important document and should be retained.

We hereby declare that this product(s) complies with the following legislation:

2009/125/EC Ecodesign Directive
2014/30/EU Electromagnetic Compatibility Directive
2014/35/EU Low Voltage Directive
2011/65/EU Restriction of Hazardous Substances (RoHS) Directive

The following standards have been applied to the product(s):

EN 60034-5:2007+A1, IEC 62321-5:2013, IEC 62321-6:2015, IEC 62321-8:2017, EN 60034-1:2010,
IEC 62321-4:2013+AMD1:2017, EN ISO 17075-1:2017, IEC 62321-7-1:2015, IEC 62321-7-2:2017,
IEC 62321-3-1:2013

The technical documentation required to demonstrate that the product(s) meet(s) the requirement(s) of the aforementioned legislation has been compiled and is available for inspection by the relevant enforcement authorities.

The UKCA mark was first applied in: 2025

Product Description: Ventilator Plate Fan
Model Number(s): CAF16
Serial/Batch Number: Refer to product/packaging label
Date of Issue: 22/08/2025

Signed:

J.A Clarke
Director



Fitzwilliam Hall, Fitzwilliam Place, Dublin 2

DECLARATION OF CONFORMITY

This is an important document and should be retained.

We hereby declare that this product(s) complies with the following legislation:

2009/125/EC Ecodesign Directive
2014/30/EU Electromagnetic Compatibility Directive
2014/35/EU Low Voltage Directive
2011/65/EU Restriction of Hazardous Substances (RoHS) Directive

The following standards have been applied to the product(s):

EN 60034-5:2007+A1, IEC 62321-5:2013, IEC 62321-6:2015, IEC 62321-8:2017, EN 60034-1:2010,
IEC 62321-4:2013+AMD1:2017, EN ISO 17075-1:2017, IEC 62321-7-1:2015, IEC 62321-7-2:2017,
IEC 62321-3-1:2013

The technical documentation required to demonstrate that the product(s) meet(s) the requirement(s) of the aforementioned legislation has been compiled and is available for inspection by the relevant enforcement authorities.

The CE mark was first applied in: 2025

Product Description: Ventilator Plate Fan
Model Number(s): CAF16
Serial/Batch Number: Refer to product/packaging label
Date of Issue: 22/08/2025

Signed:

J.A Clarke
Director

A SELECTION FROM THE VAST RANGE OF

Clarke®

QUALITY PRODUCTS



AIR COMPRESSORS
From DIY to industrial, Plus air tools, spray guns and accessories.

GENERATORS
Prime duty or emergency standby for business, home and leisure.

POWER WASHERS
Hot and cold, electric and engine driven - we have what you need

WELDERS
Mig, Arc, Tig and Spot. From DIY to auto/industrial.

METALWORKING
Drills, grinders and saws for DIY and professional use.

WOODWORKING
Saws, sanders, lathes, mortisers and dust extraction.

HYDRAULICS
Cranes, body repair kits, transmission jacks for all types of workshop use.

WATER PUMPS
Submersible, electric and engine driven for DIY, agriculture and industry.

POWERTOOLS
Angle grinders, cordless drill sets, saws and sanders.

STARTERS/CHARGERS
All sizes for car and commercial use.



PARTS & SERVICE: 0208 988 7400

Parts Enquiries
Parts@clarkeinternational.com

Servicing & Technical Enquiries
Service@clarkeinternational.com

SALES: UK 01992 565333 or Export 00 44 (0)1992 565335

Clarke® INTERNATIONAL Hemnall Street, Epping, Essex CM16 4LG
www.clarkeinternational.com